



4x4 HDMI 2.0 Matrix with output 4K to 1080p downscaling and display control 18Gbps

This high-performance HDMI Matrix Switcher can switch any of these four HDMI 2.0 sources to four HDMI 2.0 displays. Each input and output supports up to 4K60 444 resolution and HDCP 2.2. The outputs can be individually scaled for 1080p. De-embedded audio as analog L/R and coaxial is available for both outputs. The ARC function can return display device audio to coaxial port output only. Advanced EDID management is supported with its 18Gbps bandwidth and additional features with the latest HDMI standards. This switcher can be controlled from the front panel, RS-232, IR remote, or TCP/IP.

Feature Highlights

- HDMI 2.0, HDCP 2.2 / HDCP 1.4, and DVI 1.0 compliant
- Four 18G HDMI 2.0 video inputs support up to 4K60 444 resolution
- Four 18G HDMI 2.0 video outputs support up to 4K60 444 resolution
- Four outputs can be individually scaled for 4K→1080p
- De-embedded audio to analog L/R and Coaxial ports output
- ARC audio returns to the coaxial port's output only
- Built-in Web GUI for TCP/IP control
- Advanced EDID management supported
- Four methods of control: Front panel, RS-232, IR remote, and TCP/IP
- Compact design for easy and flexible installation

SPECIFICATIONS

HDMI Compliance	HDMI 2.0
HDCP Compliance	HDCP 2.2 and HDCP 1.4
Video Bandwidth	18 Gbps
Video Resolution	4K2K 50/60Hz 4:4:4 4K2K 50/60Hz 4:2:0 4K2K 30Hz 4:4:4 1080p, 1080i, 720p, 720i, 480p, 480i All HDMI 3D TV formats All PC resolutions including 1920 x 1200
Output Scaling	4K to 1080p
3D Support	Yes
Color Space	RGB, YCbCr4:4:4, YCbCr4:2:2, YCbCr 4:2:0
Color Depth	8-bit, 10-bit, 12-bit [1080P, 4K30Hz, 4K60Hz (YCbCr 4:2:0)] 8-bit [4K60Hz (YCbCr 4:4:4)]
HDMI Audio For-mats	PCM2.0/5.1/7.1CH, Dolby Digital/Plus/EX, Dolby True HD, DTS, DTS-EX, DTS-96/24, DTS High Res, DTS-HD Master Audio, DSD
Coaxial Audio For-mats	PCM2.0, Dolby Digital / Plus, DTS 2.0/5.1
L/R Audio Formats	PCM2.0CH
HDR Support	HDR10, HDR10+. Dolby Vision, HLG
ESD Protection	Human-body Model: ±8kV (Air-gap discharge), ±4kV (Contact discharge)

MECHANICAL

Housing	Metal Enclosure
Color	Black
Dimensions	220mm (W)×105mm (D)×44mm (H)
Weight	792g
Power Supply	Input: AC100~240V 50/60Hz Output: DC12V/2.5A (Locking connector)
Power Consumption	10W (max), 1.56W (Standby)
Operating Temperature	0°C ~ 40°C / 32°F ~ 104°F
Storage Temperature	-20°C ~ 60°C / -4°F ~ 140°F
Relative Humidity	20~90% RH (Non-Condensation)

CONNECTIONS

Input Ports	4×HDMI Type A [19-pin female]
Output Ports	4×HDMI Type A [19-pin female] 4×L/R audio out [3.5mm Stereo Mini-jack] 4×COAX audio out [RCA]
Control ports	1x TCP/IP [RJ45] 1x RS-232[3-pin phoenix connector] 1x IR EXT [3.5mm Stereo Mini-jack]

Resolution / Cable Length	4K60 - Feet / Meters	4K30 - Feet / Meters	1080P60 - Feet / Meters
HDMI IN / OUT	16ft / 5M	32ft / 10M	50ft / 15M

The use of "Premium High Speed HDMI" cable is highly recommended.

APPLICATION EXAMPLE

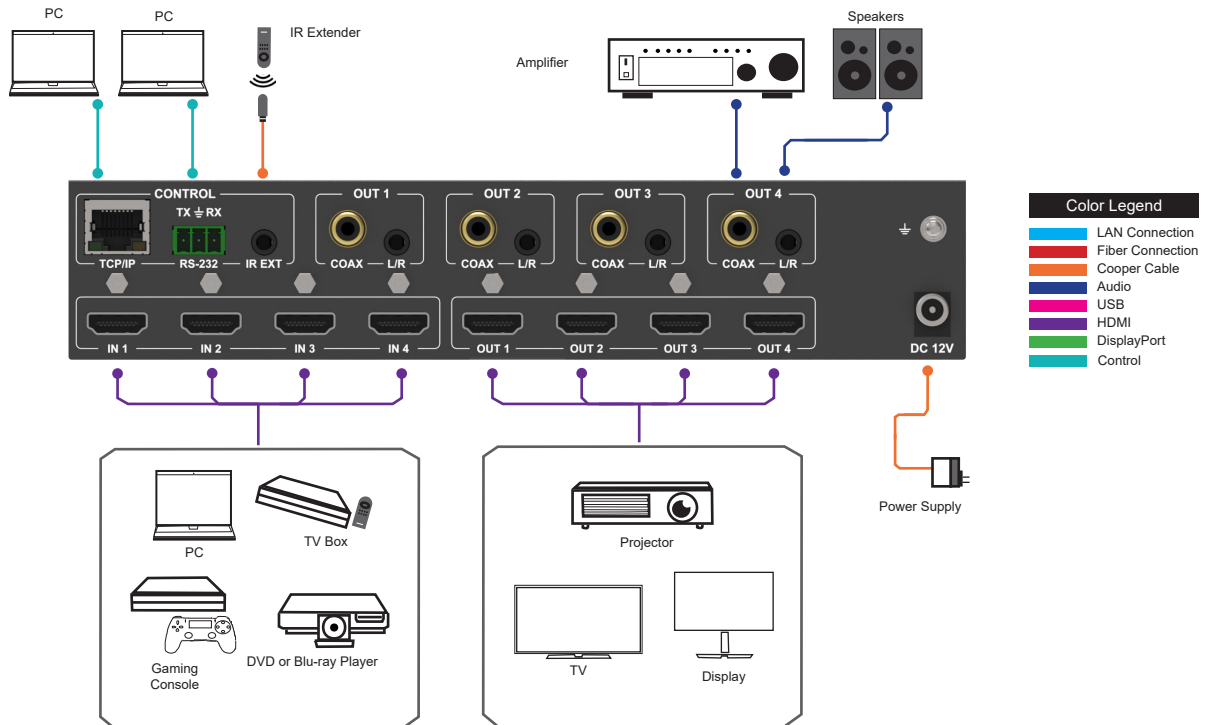

Applications

Digital Signage, Conference Rooms, Operating Rooms and Audio-Video Rooms